

Product overview

Batteries for Marine and Leisure

Equipment Li-Ion EV2500S



Part number	EV2500S
Technology	Li-Ion
EAN/GTIN	3661024037990
Voltage	12 V
Capacity	200.0 Ah
Watt hour	2500 Wh
Length	485 mm
Width	170 mm
Height	240 mm
Box size	F51
Polarity	ETN 1
Terminal Type	Female M8
Hold Down	B0
Weights (subject of variation)	25.70 kg

Polarity



Terminal Type

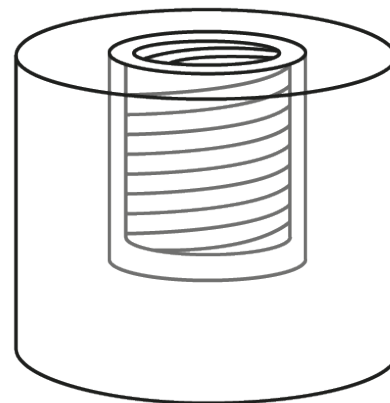

Hold Down



Design, features and specifications are subject to change without notice. We disclaim any representation or warranty, express or implied, concerning the data or recommendations, and in no event shall be liable for any loss or damage claimed to have arisen as a result. Some products may not be available in your local market.